

TECHNICAL MANUAL

ORGANIZATIONAL, DIRECT SUPPORT, AND GENERAL SUPPORT MAINTENANCE

REPAIR PARTS AND SPECIAL TOOLS LISTS

FOR

MAINTENANCE KIT, ELECTRONIC EQUIPMENT MK-1004A/ARC

(NSN 5821-00-100-4300)

HEADQUARTERS, DEPARTMENT OF THE ARMY

DECEMBER 1978

TECHNICAL MANUAL }
No. 11-6625-2609-24P }

HEADQUARTERS
DEPARTMENT OF THE ARMY
WASHINGTON, DC, 15 December 1978

**ORGANIZATIONAL, DIRECT SUPPORT, AND GENERAL SUPPORT MAINTENANCE
REPAIR PARTS AND SPECIAL TOOLS LISTS
FOR
MAINTENANCE KIT, ELECTRONIC EQUIPMENT MK-1004A/ARC
(NSN 5821-00-100-4300)
Current as of 28 July 1978**

REPORTING OF ERRORS

You can improve this manual by recommending improvements using DA Form 2028-2 located in the back of the manual. Simply tear out the self addressed form, fill it out as shown on the sample, fold it where shown, and drop it in the mail.

If there are no blank DA Form 2028-2 in the back of your manual, use the standard DA Form 2028 (Recommended Changes to Publications and Blank Forms) and forward to the Commander, US Army Communications and Electronics Materiel Readiness Command, ATTN: DRSEL-ME-MQ, Fort Monmouth, NJ 07703.

In either case a reply will be furnished direct to you.

Table of Contents

	Page	Illus Figure
SECTION I. Introduction	1	
II. Repair parts list	5	
Group 00 Maintenance Kit, Electronic Equipment MK-1004A/ARC	5	1
01 Test Panel SB-3716(P)/ARC (Modified)	9	2
02 Intercommunication Set C-1611D/AIC (See TM 11-5831-201-20P and TM 11-5831-201-34P for parts)		
03 Control, Radio Set C-7197/ARC (See TM 11-5831-277-20P and TM 11-5821-277-35P for parts)		
SECTION III. Special tools list (Not applicable)		
IV. National stock number and part number index	12	

*This manual supersedes so much of TM 11-6625-1635-24P, 20 August 1973 as pertains to the MK-1004A/ARC.

SECTION I INTRODUCTION

1. Scope

This manual lists spares and repair parts; special tools; special test, measurement, and diagnostic equipment (TMDE), and other special support equipment required for performance of organizational, direct support, and general support maintenance of the MK-1004A/ARC. It authorizes the requisitioning and issue of spares and repair parts as indicated by the source and maintenance codes.

2. General

This Repair Parts and Special Tools Lists is divided into the following sections:

a. Section II. Repair Parts List. A list of spares and repair parts authorized for use in the performance of maintenance. The list also includes parts which must be removed for replacement of the authorized parts. Parts lists are composed of functional groups in numeric sequence, with the parts in each group listed in figure and item number sequence.

b. Section III. Special Tools List. Not applicable.

c. Section IV. National Stock Number and Part Number Index. A list, in National item identification number (NIIN) sequence, of all National stock numbers (NSN) appearing in the listings, followed by a list, in alphameric sequence, of all part numbers appearing in the listings. National stock numbers and part numbers are cross-referenced to each illustration figure and item number appearance.

3. Explanation of Columns

a. Illustration. This column is divided as follows:

(1) *Figure number.* Indicates the figure number of the illustration on which the item is shown.

(2) *Item number.* The number used to identify item called out in the illustration.

b. Source, Maintenance, and Recoverability (SMR) Codes.

(1) *Source code.* Source codes indicate the manner of acquiring support items for maintenance, repair, or overhaul of end items. Source codes are entered in the first and second positions of the Uniform SMR Code format as follows:

Code	Definition
PA	Item procured and stocked for anticipated or known usage.
XD	A support item that is not stocked. When required, item will be procured through normal supply channels.

NOTE

Cannibalization or salvage may be used as a source of supply for any items source coded above except those coded XA and aircraft support items as restricted by AR 700-42.

(2) *Maintenance code.* Maintenance codes are assigned to indicate the levels of maintenance authorized to USE and REPAIR support items. The maintenance codes are entered in the third and fourth positions of the Uniform SMR Code format as follows:

(a) The maintenance code entered in the third position will indicate the lowest maintenance level authorized to remove, replace, and use the support item. The maintenance code entered in the third position will indicate one of the following levels of maintenance:

Code	Application/Explanation
O—	Support item is removed, replaced, used at the organizational level.
F—	Support item is removed, replaced, used at the direct support level.

(b) The maintenance code entered in the fourth position indicates whether the item is to be repaired and identifies the lowest maintenance level with the capability to perform complete repair (i.e., all authorized maintenance functions). This position will contain one of the following maintenance codes:

Code	Application/Explanation
F—	The lowest maintenance level capable of complete repair of the support item is the direct support level.
D—	The lowest maintenance level capable of complete repair of the support item is the depot level.
Z—	Nonreparable. No repair is authorized.

(3) *Recoverability code.* Recoverability codes are assigned to support items to indicate the disposition action on unserviceable items. The recoverability code is entered in the fifth position of the Uniform SMR Code format as follows:

Recoverability Code	Definition
Z—	Nonreparable item. When unserviceable, condemn and dispose at the level indicated in position 3.
F—	Reparable item. When uneconomically repairable, condemn and dispose at the direct support level.
D—	Reparable item. When beyond lower level repair capability, return to depot. Con-

Recoverability
Code

Definition

demanation and disposal not authorized below depot level.

c. National Stock Number. Indicates the National stock number assigned to the item and will be used for requisitioning purposes.

d. Part Number. Indicates the primary number used by the manufacturer (individual, company, firm, corporation, or Government activity), which controls the design and characteristics of the item by means of its engineering drawings, specifications, standards, and inspection requirements to identify an item or range of items.

NOTE

When a stock numbered item is requisitioned, the repair part received may have a different part number than the part being replaced.

e. Federal Supply Code for Manufacturer (FSCM). The FSCM is a 5-digit numeric code listed in SB 708-42 which is used to identify the manufacturer, distributor, or Government agency, etc.

f. Description. Indicates the Federal item name and, if required, a minimum description to identify the item.

g. Unit of Measure (U/M). Indicates the standard of the basic quantity of the listed item as used in performing the actual maintenance function. This measure is expressed by a two-character alphabetical abbreviation (e.g., ea, in, pr, etc). When the unit of measure differs from the unit of issue, the lowest unit of issue that will satisfy the required units of measure will be requisitioned.

h. Quantity Incorporated in Unit. Indicates the quantity of the item used in the breakout shown on the illustration figure, which is prepared for a functional group, subfunctional group, or an assembly.

4. Special Information

The following publications pertain to the MK-1004A/ARC and its components:

TM 11-5821-277-20P, Radio Sets AN/ARC-134 and AN/ARC-134A

TM 11-5821-277-35P, Radio Sets AN/ARG-134 and AN/ARC-134A

TM 11-5831-201-20, Control, Intercommunication

Set C-1611D/AIC and Discriminator, Discrete Signal MD-736/A

TM 11-5831-201-20P, Control, Intercommunication Set C-1611D/AIC and Discriminator, Discrete Signal MD-736/A

TM 11-5831-201-34P, Control, Intercommunication Set C-1611D/AIC and Discriminator, Discrete MD-736/A

TM 11-5831-201-35, Control, Intercommunication Set C1611D/AIC and Discriminator, Discrete Signal MD-736/A

TM 11-6625-1635-24P, Maintenance Kits, Electronic Equipment MK-1004/ARC and MK-1004A/ARC

TM 11-6625-2609-12, Maintenance Kit, Electronic Equipment MK-1004A/ARC

TM 11-6625-2609-34, Maintenance Kit, Electronic Equipment MK-1004A/ARC

5. How to Locate Repair Parts

a. When National stock number or part number is unknown.

(1) *First.* Using the table of contents, determine the functional group within which the item belongs. This is necessary since illustrations are prepared for functional groups and listings are divided into the same groups.

(2) *Second.* Find the illustration covering the functional group to which the item belongs.

(3) *Third.* Identify the item on the illustration and note the illustration figure and item number of the item.

(4) *Fourth.* Using the Repair Parts Listing, find the figure and item number noted on the illustration.

b. When National stock number or part number is known.

(1) *First.* Using the Index of National Stock Numbers and Part Numbers, find the pertinent National stock number or part number. This index is in NIIN sequence followed by a list of part numbers in alphameric sequence, cross-referenced to the illustration figure number and item number.

(2) *Second.* After finding the figure and item number, locate the *figure* and item number in the repair parts list.

6. Abbreviations

Not applicable.

(Next printed page is 4.)

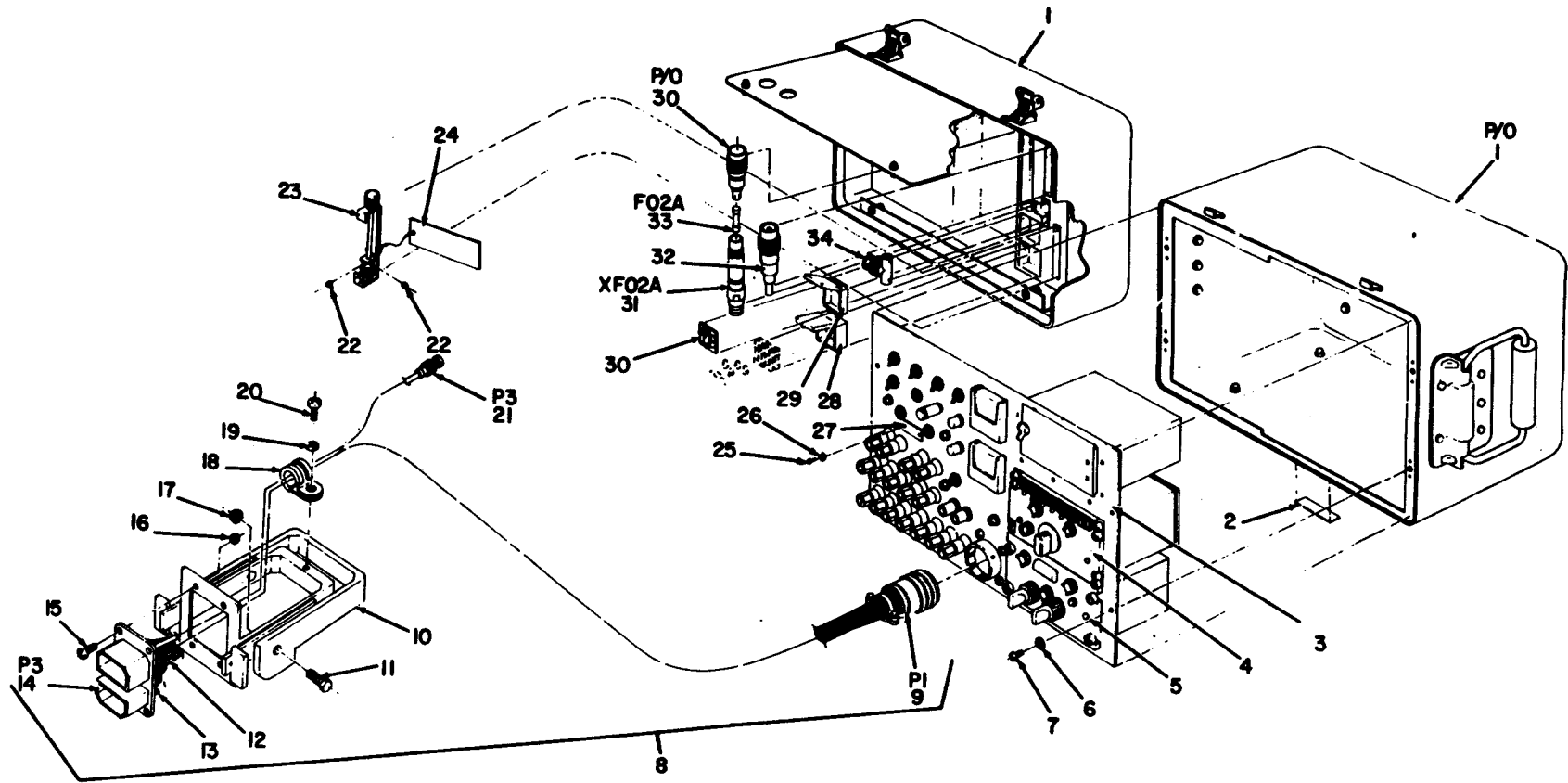

EL5PG001

Figure 1. Maintenance Kit, Electronic Equipment MK-1004A/ARC.

SECTION II (1) ILLUSTRATION (A) (B) FIG ITEM NO NO		(2) SMR CODE	(3) NATIONAL STOCK NUMBER	(4) PART NUMBER	(5) FSCM	TM11-6625-2609-24P (6) DESCRIPTION	(7) USABLE ON CODE U/M	(8) QTY INC IN UNIT
						GROUP 00 MAINTENANCE KIT,ELECTRONIC		
						EQUIPMENT MK-1004A/ARC		
1	1	PAFZZ	5821-00-108-6316	CY7345ARC	80058	CASE, ELEC EQPT	EA	1
1	2	XDFZZ		266458-0001	65597	PLATE, IDENT	EA	1
1	3	PAFFF	5821-00-108-6314	S83716PARC	80058	TEST PANEL, ELEC	EA	1
1	4	PAFDD	5831-00-933-9822	C1611DAIC	80058	CONTROL, INTERCOMM	EA	1
1	5	PAFDD	5821-00-905-9935	C7197ARC134	80058	CONTROL, RADIO SET	EA	1
1	6	PAFZZ	5310-00-619-1148	MS15795-808	96906	WASHER, FLAT	EA	8
1	7	PAFZZ	5305-00-059-3660	MS51958-64	96906	SCREW, MACHINE	EA	4
1	8	XDFFF		732563-0001	65597	CABLE ASSY, SP, ELEC	EA	1
1	9	PAFZZ	5935-00-892-9329	MS3116F22-55P	96906	CONNECTOR, PLUG, ELEC	EA	1
1	10	XDFZZ		118791-0001	65597	EXTRACTOR ASSEMBLY	EA	1
1	11	PAFZZ	5306-00-087-1628	MS16208-7	96906	BOLT, MACHINE	EA	2
1	12	PAFZZ	5940-00-144-2269	320562	00779	SPLICE, CONDUCTOR	EA	4
1	13	PAFZZ	5940-00-173-8456	2522-06-00	78189	TERMINAL, LUG	EA	1
1	14	PAFZZ	5935-00-951-5033	DPX2F40C1SF40C1S 3380003	71468	CONNECTOR, PLUG, ELEC	EA	1
1	15	PAFZZ	5305-00-068-6605	MS24693C6	96906	SCREW, MACHINE	EA	4
1	16	PAFZZ	5310-00-982-5000	MS21045C04	96906	NUT, SLFLKG, HEXAGON	EA	4
1	17	PAFZZ	5310-00-241-6604	MS17830-4C	96906	NUT, SLFLKG, HEXAGON	EA	2
1	18	PAFZZ	5340-00-565-0004	MS21919DG10	96906	CLAMP, LOOP	EA	1
1	19	PAFZZ	5310-00-933-8120	MS35338-138	96906	WASHER, LOCK	EA	1
1	20	PAFZZ	5305-00-059-3657	MS51958-61	96906	SCREW, MACHINE	EA	1
1	21	PAFZZ	5935-00-835-0508	MILC39012-16	81349	CONNECTOR, PLUG, ELEC	EA	1
1	22	PAFZZ	5305-00-717-6955	MS51963-1	96906	SETSCREW FLUTED SKT	EA	2
1	23	PAFFF	5120-00-949-6692	67606-1	65597	ALIGNMENT TOOL ELEK	EA	1
1	24	XDFZZ		104826-0001	65597	TAG, CAUTION	EA	1
1	25	PAFZZ	5305-00-054-5637	MS51957-3	96906	SCREW, MACHINE	EA	2
1	26	PAFZZ	5310-00-928-2690	MS35338-134	96906	WASHER, LOCK	EA	2
1	27	XDFZZ		266460-0001	65597	PLATE, IDENT	EA	1
1	28	XDFZZ		083644-0001	65597	BOX, PLASTIC, SMALL	EA	1
1	29	XDFZZ		1CA	28307	BOX, PLASTIC, SMALL	EA	1
1	30	PAFZZ	5821-00-933-9606	RF218ARC	80058	DETECTOR, RF	EA	1
1	31	PAFZZ	5920-00-636-0679	11509A	28480	FUSEHOLDER	EA	1
1	32	PAFZZ	5985-00-491-4305	CN1174U	80058	ATTENUATOR, FIXED	EA	1
1	33	PAFZZ	5920-00-232-3675	F01A250V1-16A	81349	FUSE, CARTRIDGE	EA	1
1	34	PAFZZ	5935-00-201-2411	UG274AU	81349	ADAPTER, CONNECTOR	EA	1

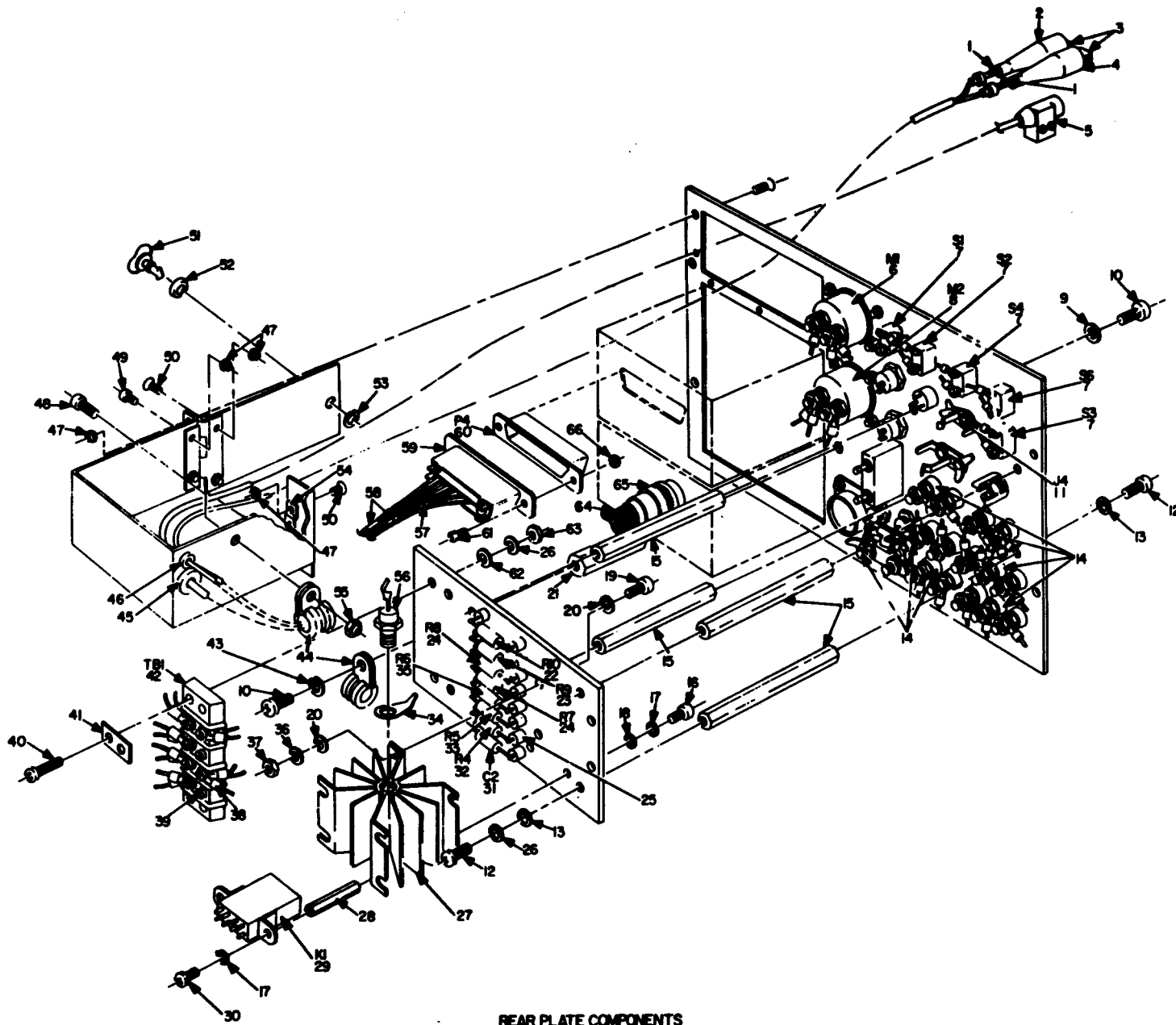

REAR PLATE COMPONENTS

EL5P8002

Figure 2. Test Panel SB-3716(P)/ARC (Modified) (Sheet 1 of 2).

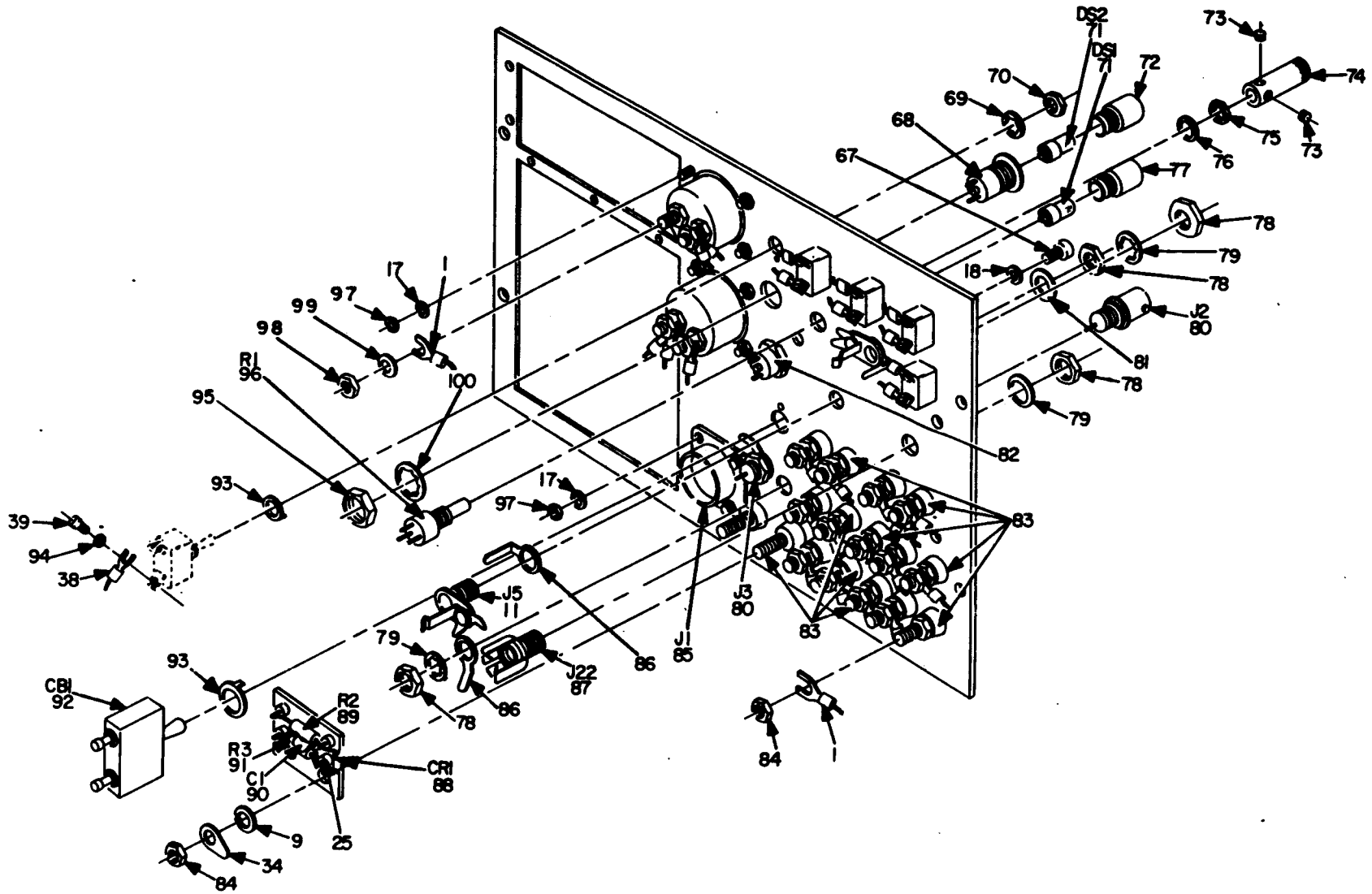

PANEL MOUNTED COMPONENTS

EL5PG003

Figure 2. Test Panel SB-3716(P)/ARC (Modified) (Sheet 2 of 2).

SECTION II (1) ILLUSTRATION (A) (B) FIG ITEM NO NO		(2) SMR CODE	(3) NATIONAL STOCK NUMBER	(4) PART NUMBER	(5) FSCM	TM11-6625-2609-24P (6) DESCRIPTION	(7) USABLE ON CODE U/M	(8) QTY INC IN UNIT
						GROUP 01 TEST PANEL SB-3716(P)/ARC (MODIFIED)		
2	1	PAFZZ	5940-00-666-3357	32050	00779	TERMINAL, LUG	EA	26
2	2	PAFZZ	5970-00-410-2548	028255-0002	65597	CABLE NIPPLE, ELEC	EA	1
2	3	PAFZZ	5999-00-204-8350	25C	76545	CLIP, ELECTRICAL	EA	2
2	4	PAFZZ	5975-00-988-0649	26BLACK	76545	CABLE NIPPLE, ELEC	EA	1
2	5	PAFZZ	5935-00-553-9352	U94AU	80058	CONNECTOR, PLUG, ELEC	EA	1
2	6	PAFZZ	6625-00-931-4489	1212-02435	55026	AMMETER	EA	1
2	7	PAFZZ	5930-00-655-1514	MS35058-22	96906	SWITCH, TOGGLE	EA	5
2	8	PAFZZ	6625-00-442-0105	1212-9545	55026	VOLTMETER	EA	1
2	9	PAFZZ	5310-00-167-0812	AN960C10L	88044	WASHER, FLAT	EA	3
2	10	PAFZZ	5305-00-059-3658	MS51958-62	96906	SCREW, MACHINE	EA	2
2	11	PAFZZ	5935-00-504-4023	B113812	37942	JACK, TELEPHONE TIP	EA	2
2	12	PAFZZ	5305-00-054-6653	MS51957-29	96906	SCREW, MACHINE	EA	8
2	13	PAFZZ	5310-00-722-5998	MS15795-805	96906	WASHER, FLAT	EA	19
2	14	PAFZZ	5940-00-269-2219	DF308C	58474	POST, BINDING	EA	7
2	15	XDFZZ		270710-0001	65597	POST, ELEC-MECH-EQPT	EA	4
2	16	PAFZZ	5305-00-054-5649	MS51957-15	96906	SCREW, MACHINE	EA	6
2	17	PAFZZ	5310-00-933-8118	MS35338-135	96906	WASHER, LOCK	EA	26
2	18	PAFZZ	5310-00-595-6211	MS15795-803	96906	WASHER, FLAT	EA	10
2	19	PAFZZ	5305-00-054-6670	MS51957-45	96906	SCREW, MACHINE	EA	4
2	20	PAFZZ	5310-00-880-5978	MS15795-807	96906	WASHER, FLAT	EA	18
2	21	XDFZZ	5340-00-259-1113	270713-0001	65597	POST, ELEC-MECH EQPT	EA	1
2	22	PAFZZ	5905-00-228-6088	RCR32G331JS	81349	RESISTOR, FXD, CMPSN	EA	1
2	23	PAFZZ	5905-00-106-1247	RCR32G221JS	81349	RESISTOR, FIXED, CMPSN	EA	1
2	24	PAFZZ	5905-00-110-0991	RCR32G151JS	81349	RESISTOR, FXED, CMPSN	EA	2
2	25	PAFZZ	5940-00-834-9660	ST1000SL	98291	TERMINAL, STUD	EA	20
2	26	PAFZZ	5310-00-011-1041	MS35338-79	96906	WASHER, LOCK	EA	8
2	27	PAFZZ	5999-00-829-2683	NC302M	05820	HEAT SINK	EA	1
2	28	XDFZZ		270709-0001	65597	POST, ELEC-MECH EQPT	EA	2
2	29	PAFZZ	5945-00-068-6429	WKJ6D26-5VDC	02288	RELAY, ARMATURE	EA	1
2	30	PAFZZ	5305-00-054-5647	MS51957-13	96906	SCREW, MACHINE	EA	4
2	31	PAFZZ	5910-00-934-2924	M39003-01-2139	81349	CAPACITOR, ELECTLT	EA	1
2	32	PAFZZ	5905-00-131-1256	RCR32G820JS	81349	RESISTOR, FXD, CMPSN	EA	1
2	33	PAFZZ	5905-00-228-6081	RCR32G121JS	81349	RESISTOR, FXD, CMPSN	EA	1
2	34	PAFZZ	5940-00-838-7938	2118-12-00	78189	TERMINAL, LUG	EA	3
2	35	PAFZZ	5905-00-141-0720	RCR32G330JS	81349	RESISTOR, FIXED, CMPSN	EA	1
2	36	PAFZZ	5310-00-054-1830	MS35338-80	96906	WASHER, LOCK	EA	4
2	37	PAFZZ	5310-00-934-9759	MS35649-284	96906	NUT, PLAIN, HEXAGON	EA	10
2	38	PAFZZ	5940-00-636-5593	34541	00779	TERMINAL, LUG	EA	25

SECTION II		TM11-6625-2609-24P						
(1)	(2)	(3)	(4)	(5)	(6)	(7)	(8)	
ILLUSTRATION					DESCRIPTION		QTY	
(A)	(B)	NATIONAL	PART	FSCM		USABLE ON CODE	INC	
FIG	ITEM	STOCK	NUMBER			U/M	IN	
NO	NO	NUMBER	NUMBER				UNIT	
2	39	XDFZZ		101052-0200	65597	SCREW, MACHINE	EA	22
2	40	PAFZZ	5305-00-054-6656	MS51957-32	96906	SCREW, MACHINE	EA	4
2	41	PAFZZ	5940-00-502-8294	601SP	75382	PLATE, MENDING	EA	2
2	42	PAFZZ	5940-00-318-6586	601-3700-4	75382	TERMINAL BOARD	EA	1
2	43	PAFZZ	5310-00-933-8120	MS35338-138	96906	WASHER, LOCK	EA	19
2	44	PAFZZ	5340-00-205-6302	MS21919DG5	96906	CLAMP, LOOP	EA	2
2	45	PAFZZ	5325-00-276-6228	MS35489-9	96906	GROMMET, RUBBER	EA	1
2	46	PAFZZ	5325-00-174-5317	MS35489-4	96906	GROMMET, RUBBER	EA	1
2	47	PAFZZ	5310-00-622-1724	68-1660-26	72962	NUT, SLFLKG, HEXAGON	EA	13
2	48	PAFZZ	5305-00-059-3659	MS51958-63	96906	SCREW, MACHINE	EA	1
2	49	PAFZZ	5305-00-054-5638	MS51957-4	96906	SCREW, MACHINE	EA	2
2	50	PAFZZ	5305-00-263-8621	103759-0004	65597	SCREW, MACHINE	EA	11
2	51	PAFZZ	5325-00-089-5311	82-12-220-16	94222	STUD, TURNLOCK FSTNR	EA	1
2	52	PAFZZ	5310-00-775-5245	82-46-101-39	94222	WASHER, RECESSED	EA	1
2	53	PAFZZ	5310-00-845-5472	82-32-101-17	94222	WASHER, SPLIT	EA	1
2	54	PAFZZ	5325-00-788-5635	82-35-302-15	94222	RECEPTACLE, TURNLOCK	EA	1
2	55	PAFZZ	5310-00-208-9255	79NM02	72962	NUT, SLFLKG, HEXAGON	EA	1
2	56	PAFZZ	5961-01-011-5692	1N3890	81349	SEMICONDUCTOR, DIODE	EA	1
2	57	PAFZZ	5940-00-144-2269	320562	00779	SPLICE, CONDUCTOR	EA	1
2	58	PAFZZ	5940-00-232-5209	320559	00779	SPLICE, CONDUCTOR	EA	2
2	59	PAFZZ	5935-00-583-8836	DC19678-3	71468	SHIELD, ELEC CONN	EA	1
2	60	PAFZZ	5935-00-820-9637	DCM37S	71468	CONNECTOR, PLUG, ELEC	EA	1
2	61	PAFZZ	5305-00-054-5648	MS51957-14	96906	SCREW, MACHINE	EA	4
2	62	PAFZZ	5310-00-880-5976	MS15795-806	96906	WASHER, FLAT	EA	4
2	63	PAFZZ	5310-00-934-9761	MS35649-264	96906	NUT, PLAIN, HEXAGON	EA	9
2	64	XDFZZ		732564-0001	65597	WIRING HARNESS BR	EA	1
2	65	PAFZZ	5935-00-914-2384	MS3116E20-39SY	96906	CONNECTOR, PLUG, ELEC	EA	1
2	66	PAFZZ	5310-00-275-1404	79NM40	72962	NUT, SLFLKG, HEXAGON	EA	2
2	67	PAFZZ	5305-00-054-5651	MS51957-17	96906	SCREW, MACHINE	EA	4
2	68	PAFZZ	6210-00-617-1551	101-5030-931	72619	LIGHT, INDICATOR	EA	1
2	69	PAFZZ	5310-00-596-4892	3010-22	78189	WASHER, LOCK	EA	6
2	70	PAFZZ	5310-00-137-3068	MS25082C21	96906	NUT, PLAIN, HEXAGON	EA	6
2	71	PAOZZ	6240-00-155-7836	MS25237-327	96906	LAMP, INCANDSCENT	EA	2
2	72	PAOZZ	6210-00-842-1679	101-931	72619	LENS, INDICATION	EA	1
2	73	PAOZZ	5305-00-805-9748	MS51053-112	96906	SETSCREW, FILTED, SKT	EA	2
2	74	PAOZZ	5355-00-914-1974	60848-1	65597	KNOB	EA	1
2	75	PAFZZ	5310-00-550-1059	M4721	01121	NUT, PLAIN, HEXAGON	EA	1
2	76	PAFZZ	5310-00-065-0179	M4748	01121	WASHER, LOCK	EA	1
2	77	PAOZZ	6210-00-842-1680	101-932	72619	LENS, INDICATOR	EA	1
2	78	XDFZZ		100022-0200	65597	NUT, PLAIN, HEXAGON	EA	6

SECTION II		TM11-6625-2609-24P						
(1)	(2)	(3)	(4)	(5)	(6)	(7)	(8)	
ILLUSTRATION					DESCRIPTION		QTY	
(A)	(B)	NATIONAL	PART	FSCM		USABLE ON CODE	INC	
FIG	ITEM	STOCK	NUMBER			U/M	IN	
NO	NO	NUMBER	NUMBER				UNIT	
2	79	PAFZZ	5310-00-180-0277	MS35333-76	96906	WASHER, LOCK	EA	5
2	80	PAFZZ	5935-00-843-9008	MS35179-1094A	96906	CONNECTOR, RCPT, ELEC	EA	2
2	81	PAFZZ	5310-00-261-7717	1720-02	78189	WASHER, LOCK	EA	1
2	82	PAOZZ	6210-00-617-1552	101-5030-932	72619	LIGHT, INDICATOR	EA	1
2	83	PAFZZ	5940-00-356-2493	OF30R2	58474	POST, BINDING	EA	9
2	84	PAFZZ	5310-00-208-9255	MS21044C3	96906	NUT, PLAIN, HEXAGON	EA	16
2	85	PAFZZ	5935-00-827-1547	MS3112E22-55S	96906	CONNECTOR, RCPT, ELEC	EA	1
2	86	XDFZZ		A131023-1	37942	TERMINAL, LUG	EA	4
2	87	PAFZZ	5935-00-192-4729	JJ033	81349	JACK, TELEPHONE TIP	EA	1
2	88	PAFZZ	5961-00-170-4430	1N34A	80131	SEMICONDUCTOR, DIODE	EA	1
2	89	PAFZZ	5905-00-247-8733	RCR32G562JS	81349	RESISTOR, FIXED, CMPSN	EA	1
2	90	PAFZZ	5910-00-138-1681	CK628X102M	81349	CAPACITOR, FXD, CER	EA	1
2	91	PAFZZ	5905-00-104-5757	RCR32G273JS	81349	RESISTOR, FXD, CMPSN	EA	1
2	92	PAFZZ	5925-00-934-3098	M39019-1-51	81349	CIRCUIT BREAKER	EA	1
2	93	PAFZZ	5310-00-999-4033	MS25081C4	96906	RING, LOCK, KEYED	EA	6
2	94	PAFZZ	5310-00-616-3555	MS35333-71	96906	WASHER, LOCK	EA	14
2	95	PAFZZ	5310-00-255-5203	035692NUT	65597	NUT, PLAIN, HEXAGON	EA	2
2	96	PAFZZ	5905-00-194-8342	GA2G036S103UA	01121	RESISTOR, VARIABLE	EA	1
2	97	PAFZZ	5310-00-934-9748	MS35649-244	96906	NUT, PLAIN, HEXAGON	EA	24
2	98	PAFZZ	5310-00-429-2274	100008-1200	65597	NUT, PLAIN, HEXAGON	EA	4
2	99	PAFZZ	5310-00-255-5143	076020-1200	65597	WASHER, FLAT	EA	4
2	100	PAFZZ	5310-00-257-6215	035692LKW	65597	WASHER, LOCK	EA	2

NOTE: LATEST NATIONAL STOCK NUMBER AND PART NUMBER ASSIGNMENTS ARE INCLUDED AT END OF INDEX

STOCK NUMBER	FIGURE NO	ITEM NO	STOCK NUMBER	FIGURE NO	ITEM NO
5310-00-011-1041	2	26	5310-00-275-1404	2	66
5310-00-054-1830	2	36	5325-00-276-6228	2	45
5305-00-054-5637	1	25	5940-00-356-2493	2	83
5305-00-054-5638	2	49	5970-00-410-2548	2	2
5305-00-054-5647	2	30	6625-00-442-0105	2	8
5305-00-054-5648	2	61	5940-00-502-8294	2	41
5305-00-054-5649	2	16	5310-00-550-1059	2	75
5305-00-054-5651	2	67	5935-00-553-9352	2	5
5305-00-054-6653	2	12	5340-00-565-0004	1	18
5305-00-054-6656	2	40	5935-00-583-8836	2	59
5305-00-059-3657	1	20	5310-00-595-6211	2	18
5305-00-059-3658	2	10	5310-00-616-3555	2	94
5305-00-059-3659	2	48	6210-00-617-1551	2	68
5305-00-059-3660	1	7	6210-00-617-1552	2	82
5310-00-065-0179	2	76	5310-00-622-1724	2	47
5945-00-068-6429	2	29	5920-00-636-0679	1	31
5305-00-068-6605	1	15	5940-00-636-5593	2	38
5325-00-089-5311	2	51	5930-00-655-1514	2	7
5905-00-104-5757	2	91	5940-00-666-3357	2	1
5905-00-106-1247	2	23	5310-00-722-5998	2	13
5821-00-108-6314	1	3	5310-00-775-5245	2	52
5821-00-108-6316	1	1	5305-00-805-9748	2	73
5905-00-110-0991	2	24	5935-00-820-9637	2	60
5905-00-131-1256	2	32	5935-00-827-1547	2	85
5310-00-137-3068	2	70	5999-00-829-2663	2	27
5910-00-138-1681	2	90	5940-00-834-9660	2	25
5905-00-141-0720	2	35	5940-00-838-7938	2	34
5940-00-144-2269	1	12	6210-00-842-1679	2	72
5940-00-144-2269	2	57	6210-00-842-1680	2	77
6240-00-155-7836	2	71	5310-00-845-5472	2	53
5961-00-170-4430	2	88	5310-00-880-5976	2	62
5940-00-173-8456	1	13	5310-00-880-5978	2	20
5310-00-180-0277	2	79	5935-00-892-9329	1	9
5935-00-192-4729	2	87	5355-00-914-1974	2	74
5935-00-201-2411	1	34	5935-00-914-2384	2	65
5310-00-208-9255	2	55	5310-00-933-8118	2	17
5905-00-228-6081	2	33	5310-00-933-8120	1	19
5905-00-228-6088	2	22	5310-00-933-8120	2	43
5940-00-232-5209	2	58	5821-00-933-9606	1	30
5310-00-241-6604	1	17	5831-00-933-9822	1	4
5905-00-247-8733	2	89	5925-00-934-3098	2	92
5310-00-255-5143	2	99	5310-00-934-9748	2	97
5310-00-255-5203	2	95	5310-00-934-9759	2	37
5310-00-257-6215	2	100	5120-00-949-6692	1	23
5340-00-259-1113	2	21	5935-00-951-5033	1	14
5310-00-261-7717	2	81	5310-00-982-5000	1	16
5305-00-263-8621	2	50	5310-00-999-4033	2	93
5940-00-269-2219	2	14	5961-01-011-5692	2	56

PART NUMBER	FSCM	FIG NO	ITEM NO	PART NUMBER	FSCM	FIG NO	ITEM NO
AN960C10L	88044	2	9	MS25081C4	96906	2	93
A131023-1	37942	2	86	MS25082C21	96906	2	70
B113812	37942	2	11	MS25237-327	96906	2	71
CK62BX102M	81349	2	90	MS3112E22-55S	96906	2	85
CN1174U	80058	1	32	MS3116E20-39SY	96906	2	65
CY/345ARC	80058	1	1	MS3116F22-55P	96906	1	9
C1611DAIC	80058	1	4	MS35C58-22	96906	2	7
C7197ARC134	80058	1	5	MS35179-1094A	96906	2	80
DCM37S	71468	2	60	MS35333-71	96906	2	94
DC19678-3	71468	2	59	MS35333-76	96906	2	79
DF308C	58474	2	14	MS35338-134	96906	1	26
DF308C	58474	2	83	MS35338-135	96906	2	17
DPX2F40C1SF40C1S33B0003	71468	1	14	MS35338-138	96906	1	19
F01A250V1-16A	81349	1	33	MS35338-138	96906	2	43
				MS35338-79	96906	2	26
JJ033	81349	2	87	MS35338-80	96906	2	36
MS15795-803	96906	2	18	MS35489-4	96906	2	46
MS15795-805	96906	2	13	MS35489-9	96906	2	45
MS15795-806	96906	2	62	MS35649-244	96906	2	97
MS15795-807	96906	2	20	MS35649-264	96906	2	63
MS15795-808	96906	1	6	MS35649-284	96906	2	37
MS16208-7	96906	1	11				
MS17830-4C	96906	1	17	MS51053-112	96906	2	73
MS21045C04	96906	1	16	MS51957-13	96906	2	30
MS21919DG10	96906	1	18	MS51957-14	96906	2	61
MS21919DG5	96906	2	44	MS51957-15	96906	2	16
MS24693C6	96906	1	15	MS51957-17	96906	2	67

PART NUMBER	FSCM	FIG NO	ITEM NO	PART NUMBER	FSCM	FIG NO	ITEM NO
MS51957-29	96906	2	12	101-5030-931	72619	2	68
MS51957-3	96906	1	25	101-5030-932	72619	2	82
MS51957-32	96906	2	40	101-931	72619	2	72
MS51957-4	96906	2	49	101-932	72619	2	77
MS51957-4	96906	2	49	101-932	72619	2	77
MS51957-45	96906	2	19	101052-0200	65597	2	39
MS51958-61	96906	1	20	103759-0004	65597	2	50
MS51958-62	96906	2	10	104826-0001	65597	1	24
MS51958-63	96906	2	48	11509A	28480	1	31
MS51958-64	96906	1	7	118791-0001	65597	1	10
M39003-01-2139	81349	2	31				
M39019-1-51	81349	2	92	1212-9545	55026	2	8
M4721	01121	2	75	1720-02	78189	2	81
M4748	01121	2	76	2118-12-00	78189	2	34
NC302M	05820	2	27	25C	76545	2	3
RCR32G121JS	81349	2	33	2522-06-00	78189	1	13
RCR32G151JS	81349	2	24	26BLACK	76545	2	4
RCR32G221JS	81349	2	23	266458-0001	65597	1	2
RCR32G273JS	81349	2	91	266460-0001	65597	1	27
RCR32G330JS	81349	2	35	270709-0001	65597	2	28
RCR32G331JS	81349	2	22	270710-0001	65597	2	28
RCR32G562JS	81349	2	89	270713-0001	65597	2	21
RCR32G820JS	81349	2	32				
RF218ARC	80058	1	30	32050	00779	2	1
SB3716PARC	80058	1	3	320559	00779	2	58
ST1000SL	98291	2	25	320562	00779	1	12
UG274AU	81349	1	34	320562	00779	2	57
U94AU	80058	2	5	34541	00779	2	38
WKJ6D26-5VDC	02288	2	29				
028255-0002	65597	2	2	601SP	75382	2	41
035692LKW	65597	2	100	60848-1	65597	2	74
035692NUT	65597	2	95	67606-1	65597	1	23
076020-1200	65597	2	99	68-1660-26	72962	2	47
				732563-0001	65597	1	8
083644-0001	65597	1	28	732564-0001	65597	2	64
1CA	28307	1	29	79NMC2	72962	2	55
1N34A	80131	2	88	79NM40	72962	2	66
1N3890	81349	2	56	82-12-220-16	94222	2	51
100008-1200	65597	2	98	82-32-101-17	94222	2	53
100022-0200	65597	2	78	82-35-302-15	94222	2	54
				82-46-101-39	94222	2	52

LATEST NATIONAL STOCK NUMBER ASSIGNMENTS

STOCK NUMBER	FIG NO	ITEM NO	STOCK NUMBER	FIG NO	ITEM NO
5305-00-054-6670	2	19	5310-00-619-1148	1	6
5306-00-087-1628	1	11			
5310-00-167-0812	2	9	5305-00-717-6955	1	22
5325-00-174-5317	2	46	5325-00-788-5635	2	54
5905-00-194-8342	2	96	5935-00-835-0508	1	21
5999-00-204-8350	2	3	5935-00-843-9008	2	80
5340-00-205-6302	2	44	5310-00-928-2690	1	26
5310-00-208-9255	2	84	6625-00-931-4489	2	6
5920-00-232-3675	1	33	5910-00-934-2924	2	31
5940-00-318-6586	2	42	5310-00-934-9761	2	63
5935-00-504-4023	2	11	5975-00-988-0649	2	4
5310-00-596-4892	2	69			

LATEST PART NUMBER ASSIGNMENTS

PART NUMBER	FSCM	FIG NO	ITEM NO	PART NUMBER	FSCM	FIG NO	ITEM NO
GA2G036S103UA	01121	2	96				
MILC39012-16	81349	1	21	1212-02435	55026	2	6
MS21044C3	96906	2	84	3010-22	78189	2	69
MS51963-1	96906	1	22	601-3700-4	75382	2	42

ADDITIONAL LATEST NATIONAL STOCK NUMBER ASSIGNMENTS

5310-00-429-2274	2	98
5985-00-491-4305	1	32
5821-00-905-9935	1	5

RECOMMENDED CHANGES TO EQUIPMENT TECHNICAL MANUALS



SOMETHING WRONG WITH THIS MANUAL?

THEN... JOT DOWN THE DOPE ABOUT IT ON THIS FORM, TEAR IT OUT, FOLD IT AND DROP IT IN THE MAIL!

FROM: (YOUR UNIT'S COMPLETE ADDRESS)

Commander
Stateside Army Depot
ATTN: AMSTA-US
Stateside, N.J. 07703

DATE 10 July 1975

PUBLICATION NUMBER

TM 11-5840-340-20P

DATE

23 Jan 78

TITLE

Radar Set AN/PRC-76

BE EXACT... PIN-POINT WHERE IT IS

IN THIS SPACE TELL WHAT IS WRONG AND WHAT SHOULD BE DONE ABOUT IT:

PAGE NO.	PARA-GRAPH	FIGURE NO.	TABLE NO.
33			
44		19	
45			

For item 2, change the NSN to read: 5835-00-134-9186.
Reason: Accuracy.

Identify the cover on the junction box (item no. 5).
Reason: It is a separate item and is not called out on figure 19.

Add the cover of the junction box as an item in the listing for figure 19.
Reason: Same as above.

TEAR ALONG DOTTED LINE

TYPED NAME, GRADE OR TITLE, AND TELEPHONE NUMBER

SSG I. M. DeSpirito 999-1776

SIGN HERE:

SSG I. M. DeSpirito

DA FORM 2028-2
1 AUG 74

P.S.--IF YOUR OUTFIT WANTS TO KNOW ABOUT YOUR MANUAL "FIND," MAKE A CARBON COPY OF THIS AND GIVE IT TO YOUR HEADQUARTERS.

FILL IN YOUR
UNIT'S ADDRESS

FOLD BACK

DEPARTMENT OF THE ARMY

OFFICIAL BUSINESS

PENALTY FOR PRIVATE USE, \$300

POSTAGE AND FEES PAID
DEPARTMENT OF THE ARMY
DDG-314



Commander
US Army Communications and
Electronics Materiel Readiness Command
ATTN: DRSEL-ME-MQ
Fort Monmouth, New Jersey 07703

TEAR ALONG DOTTED LINE

FOLD BACK

FILL IN YOUR
UNIT'S ADDRESS

FOLD BACK

DEPARTMENT OF THE ARMY

OFFICIAL BUSINESS
PENALTY FOR PRIVATE USE, \$300

POSTAGE AND FEES PAID
DEPARTMENT OF THE ARMY
DDO-314



Commander
US Army Communications and
Electronics Materiel Readiness Command
ATTN: DRSEL-ME-MQ
Fort Monmouth, New Jersey 07703

TEAR ALONG DOTTED LINE

FOLD BACK

FILL IN YOUR
UNIT'S ADDRESS

FOLD BACK

DEPARTMENT OF THE ARMY

OFFICIAL BUSINESS
PENALTY FOR PRIVATE USE, \$300

POSTAGE AND FEES PAID
DEPARTMENT OF THE ARMY
DOD-314



Commander
US Army Communications and
Electronics Materiel Readiness Command
ATTN: DRSEL-ME-MQ
Fort Monmouth, New Jersey 07703

TEAR ALONG DOTTED LINE

FOLD BACK

By Order of the Secretary of the Army:

Official:

BERNARD W. ROGERS
General, United States Army
Chief of Staff

J. C. PENNINGTON
Brigadier General, United States Army
The Adjutant General

DISTRIBUTION:

To be distributed in accordance with DA Form 12-36, Direct and General Support maintenance requirements for AN/ARC-134.

